

Retail Space for Lease



Anchor Space in Segale Retail Center

300 Andover Park West
Tukwila, WA 98188

- Prime location diagonally across from Westfield Mall in Southcenter
- Seattle's #1 Southend Retail Market
- High visibility from major intersections
- Left turns in and out from both Andover Park West and Strander Blvd
- Upscale tenant mix includes Barnes & Noble, Starbucks, Seattle Lighting, Office Depot and Sleep Country USA
- Excellent access to I-5, I-405, and SR-167

SEGALE PROPERTIES

PO Box 88028 Tukwila, WA 98138
206 575-2000 www.segaleproperties.com

Contact Diane M. Decker, CPM®
206 575-2000
ddecker@segaleproperties.com

Retail Space for Lease



Anchor Space in Segale Retail Center

300 Andover Park West
Tukwila, WA 98188

- 28,716 ± sq ft available
- Total GLA: 125,688 sq ft
- 520 parking spaces total
- Outstanding signage visibility
- 180' frontage
- 3 grade-level doors
- 2 dock-high doors
- 600 amps of power



SEGALE PROPERTIES

PO Box 88028 Tukwila, WA 98138
206 575-2000 www.segaleproperties.com

Contact Diane M. Decker, CPM®
206 575-2000
ddecke@segaleproperties.com

Retail Space for Lease

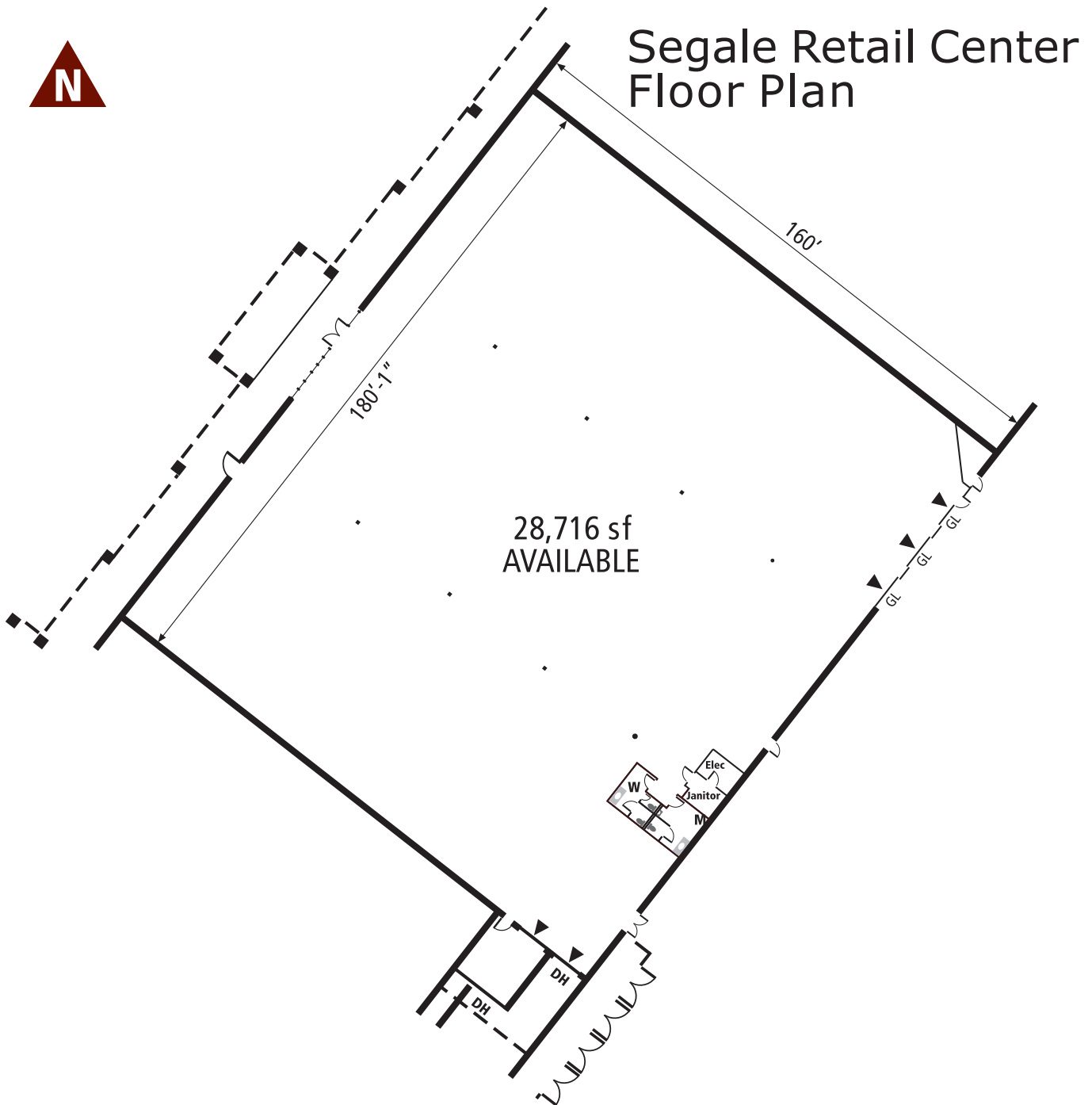

SEGALE PROPERTIES

PO Box 88028 Tukwila, WA 98138
206 575-2000 www.segaleproperties.com

Contact Diane M. Decker, CPM®
206 575-2000
ddecker@segaleproperties.com